

**CITY OF COCKBURN  
STRUCTURE PLAN**

(Delegation)  
This Structure Plan was adopted by Council on 5 / 09 / 14

Signed PP  
**DIRECTOR OF PLANNING & DEVELOPMENT**

File No: 110/09 & SP14/16 (Previously 9686)

This Structure Plan was endorsed by the Western Australian  
Planning Commission on  / /

Signed NA (Clause 6.2.14.2 of TPS3)

**DIRECTOR OF PLANNING & DEVELOPMENT**

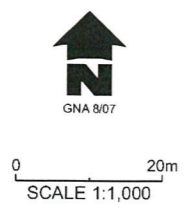
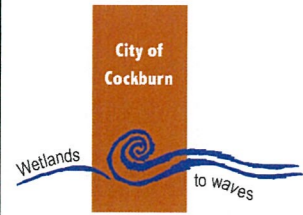
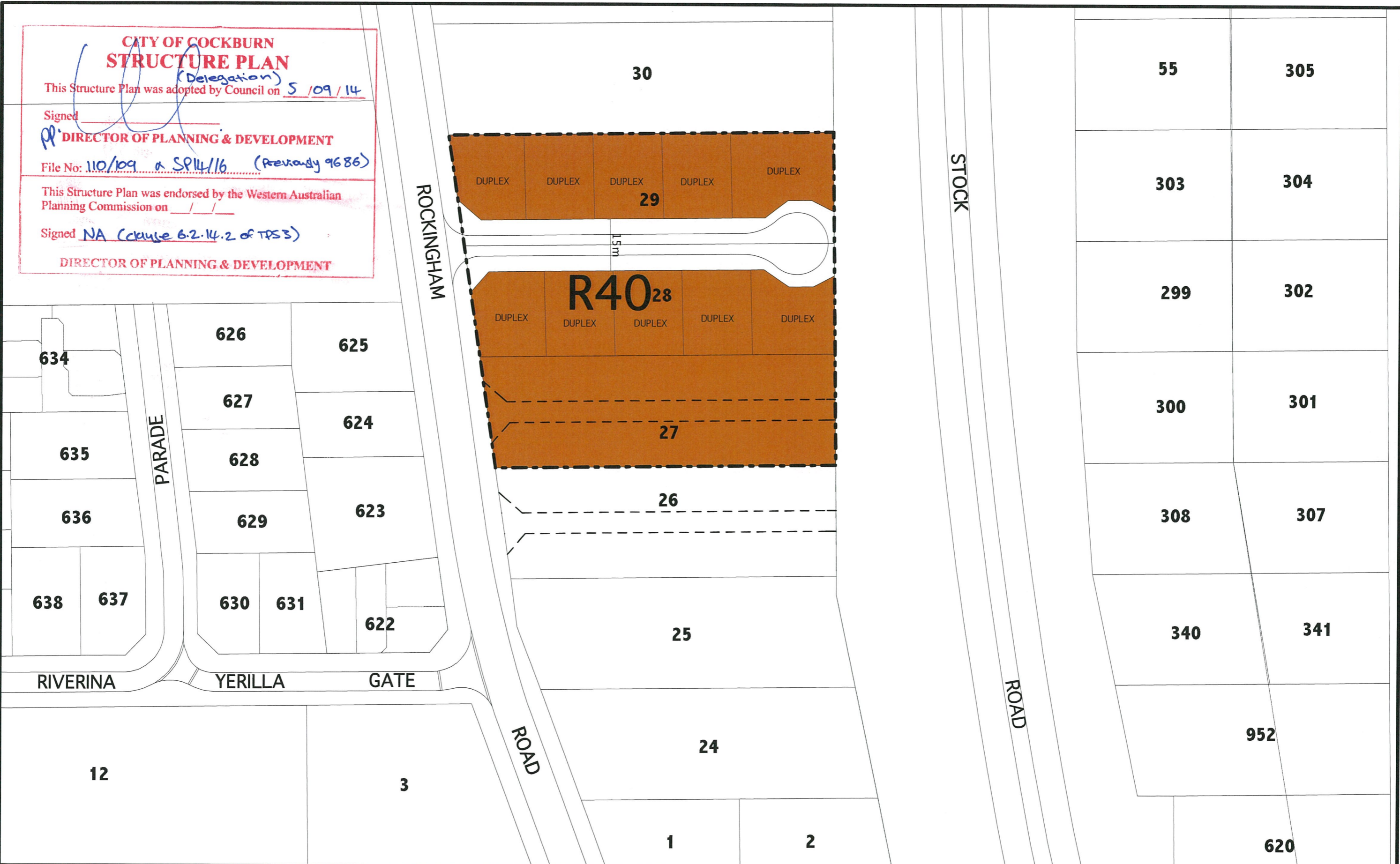

- Indicative Road Layout/ Reciprocal Rights of Access
- Structure Plan Boundary
- Residential R40

Note: In the event of a strata development, the road widths may be reduced (in accordance with SPP 3.1; R-Codes).

Original Structure Plan prepared by Burgess Design Group.  
(Date: 18/1/07 Drawing No.: NAT MUN SP)

**LOCAL STRUCTURE PLAN  
MUNSTER**  
LOTS 27, 28, 29 ROCKINGHAM ROAD, MUNSTER